





Installation Guide



Filters/Filter Cartridge Options

Sediment Filter for Cartridge Tank		Sediment/Carbon Filter for Cartridge Tank		Pleated Sediment Filter for Cartridge Tank		Cartridge Tank Cannister	
Model #	Dual Gradient Nominal Micron Ratings*	Model #	Dual Gradient Nominal Micron Ratings*	Model #	Dual Gradient Nominal Micron Ratings*	Model #	Top/Bottom Plate
CF3400-MB2501	25 Micron/1 Micron	CF3400-CT05	25 Micron/5 Micron	CF3400-PL01	1 Micron	CF3400-RF	0.010" - 0.013"
CF3400-MB2505	25 Micron/5 Micron	CF3400-CT020	25 Micron/20 Micron	CF3400-PL05	5 Micron		
CF3400-MB5005	50 Micron/5 Micron			CF3400-PL20	20 Micron		
CF3400-MB5005	50 Micron/5 Micron			CF3400-PL50	50 Micron		
							



Cartridge Tank Parts

Drawing No.	Order No.	Description	Quantity
1	C3001	CT NUT	1
2	C3002	CT CAP 2.5 NPSM	1
3	C3022	O-RING 370	1
4	C3004	CT 1.320 CENTER ADAPTER	1
5	C3000	CT HOUSING BODY	1
6	C3003	CT TANK BASE	1
7	C3007-15*	FITTING JG QC 90 ASSY	1

*includes two fittings

Optional Parts - Sold Separately

Drawing No.	Order No.	Description	Quantity
8	V3006	BYPASS ASSEMBLY	1
9	V3007-21	VERTICAL 90 UNION ADAPTER KIT	1
10	D1400-04	1191 1.320	1
11	See front page for filter options		1

Operation Specifications

Operating Pressure	Maximum Pressure: 125 PSI
Operating Temperature	Maximum Temperature: 110°F

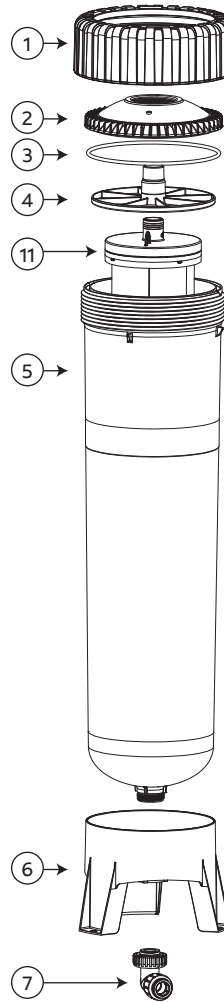

Optional Parts

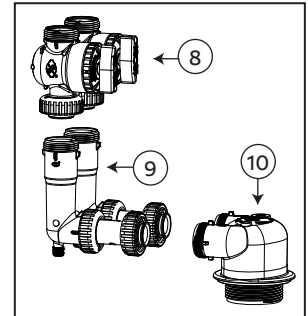

Dimensions

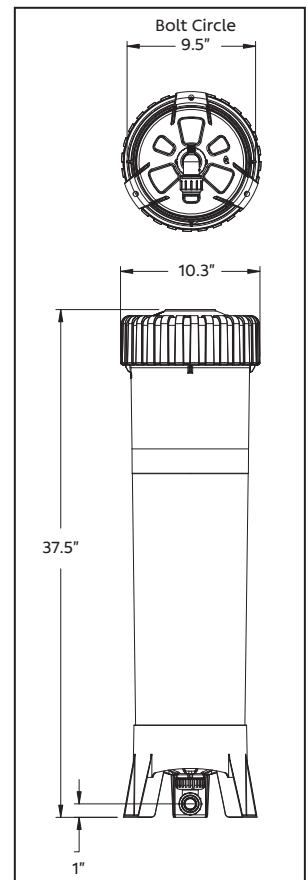

WARNING: USE ONLY SILICONE-BASED LUBRICANTS ON ALL CLACK CORPORATION COMPONENTS

HYDROCARBONS WILL DAMAGE COMPONENTS THAT CONTAIN O-RINGS AND OR PLASTIC. THIS CAN CAUSE LEAKS OR BREAKAGE. DO NOT USE LUBRICANTS THAT CONTAIN HYDROCARBONS SUCH AS VASELINE®/PETROLEUM JELLY, WD-40®, ETC. DO NOT USE CLACK CONTROL VALVE PRODUCTS ON WATER SUPPLIES THAT CONTAIN HYDROCARBONS, SUCH AS BENZENE, GASOLINE, KEROSENE, ETC.